



PAR METER

APM092



The hand held **APM 092** par meter provides accurate and cost-effective measurement for all light sources used to grow plants. It is designed to measure PAR (Photo synthetically Active Radiation) flux in wavelengths ranging from 400 to 700nm. In controlled environment agriculture (CEA), it is ideal for growers to measure light to avoid the risk of wasting energy or damaging their plants.

Features at a Glance

- Display Resolution 0.1 $\mu\text{mol}/\text{m}^2/\text{sec}$ (0-999); 1 $\mu\text{mol}/\text{m}^2/\text{sec}$ (1000-3999)
- Repeatability $\pm 1 \mu\text{mol}/\text{m}^2/\text{sec}$
- Measurement Range 0-4000 $\mu\text{mol}/\text{m}^2/\text{sec}$
- Cut-On Wavelength 400 \pm 10nm
- Cut-Off Wavelength 700 \pm 10nm
- Memory Record 100 Data log

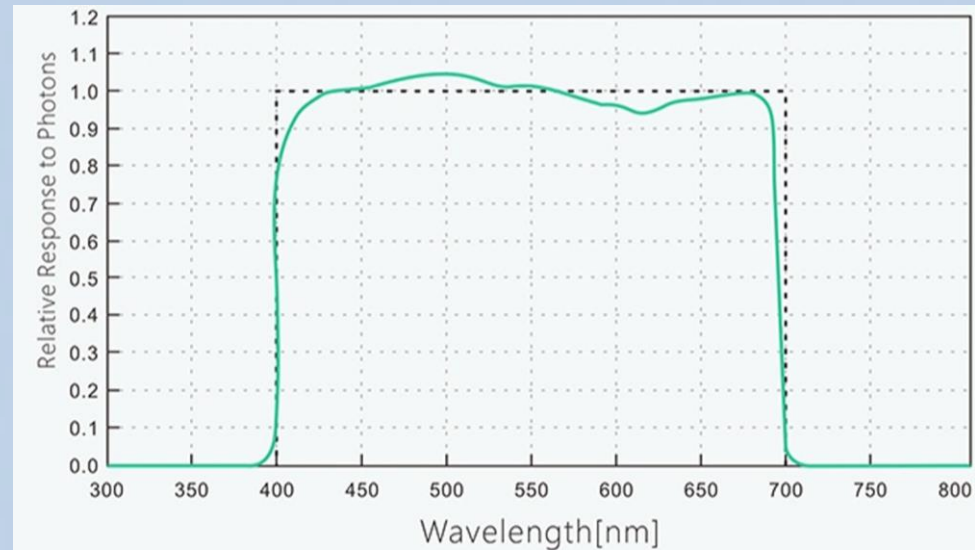

Operating Instructions

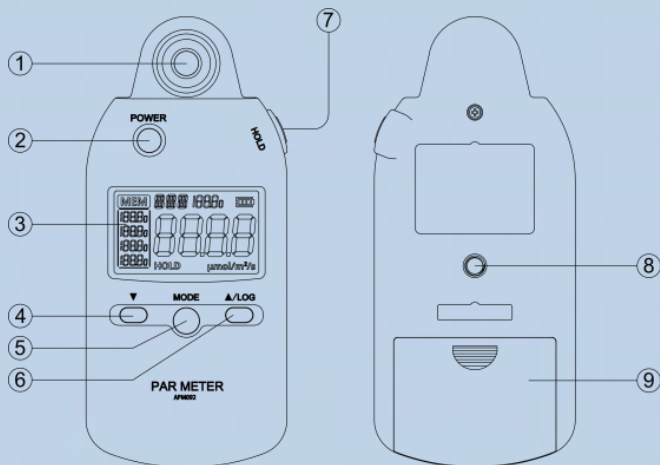

1. Sensor diffuser
2. Power Key
3. LCD display
4. Down Key
5. Mode Key
6. Up Key
7. Hold Key
8. Tripod socket 1/4 "
9. Battery Cover

Initial Setup

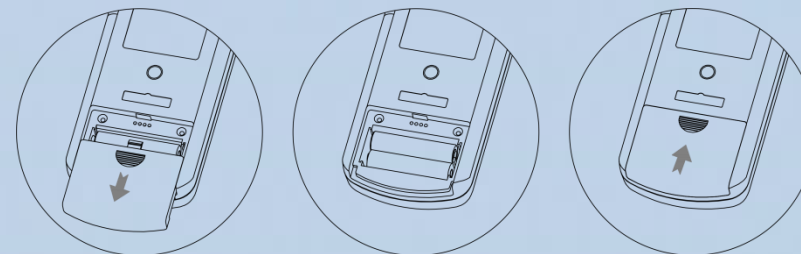

1. Open the battery cover
2. Insert two AAA batteries into the battery compartment.
3. Close the battery cover

Measurement	Specification
Operating Temperature	32°F to 122°F (0°C to 50°C)
Storage Temperature	-4°F to 140°F (-20°C to 60°C)
Operating & Storage RH	0-95%, non-condensing

PPFD Measurement	
Repeatability	+/-1 $\mu\text{mol}/\text{m}^2/\text{sec}$
Measurement Range	0-5000 $\mu\text{mol}/\text{m}^2/\text{sec}$
Display Resolution	0.1 $\mu\text{mol}/\text{m}^2/\text{sec}$ (0-999); 1 $\mu\text{mol}/\text{m}^2/\text{sec}$ (1000-5000)
Cut-On Wavelength	400+/-10nm
Cut-Off Wavelength	700+/-10nm
Power Requirements	2 x AAA batteries
Dimension	115 x 60 x 24mm
Weight	115g (without batteries and cable)

Troubleshooting	Cause	Remedy
Symptom	Power is not turned on	Turn on the power button
	Battery is empty	Replace battery
	Cable error	Please check the cable, maybe there is some electrical short

LCD main display show "----"	Sensor unit is not working	Please check the cable and redo connect.
	Cable connect error	Please check the cable and redo connect.
LCD no display, only battery icon flash	Some foreign body in RJ11 port	Please check RJ11 port, maybe there is some foreign body in RJ11 port.
	Battery is empty	Replace battery

KunShan AST Optoelectronics Co.,Ltd

No.285 North YuDai road, KunShan city, China. TEL: 0512-57319796

www.AstOpto.com. Email: JennyPan@astopto.com